

Topper



Put in bulb and put together - tighten screws to secure



Topper Base

Place assembled topper on pole and plug in. Tighten screws to secure

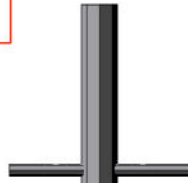

Optional crosspiece for lekos

Post

# LARGE LAMP POSTS

Decorative Base



Decorative base rests on top of hexagonal base. Screw together to secure

Slip post over 6' pipe

Hexagonal base goes over Stropini to hide sand

Plugs at bottom -  
Circuits 1 and 2 = outlets at top  
Circuit 3 = lamp post bulb

Hexagonal Wood Base



Hella sand onto Stropini base

6' Stropini Tree

Topper



Secure topper to post with screws  
Lamp already installed  
Run zip cord through length of post

Optional crosspiece for light loads only

Post

Plug zip from topper into wood base

Put post onto base - no hardware required

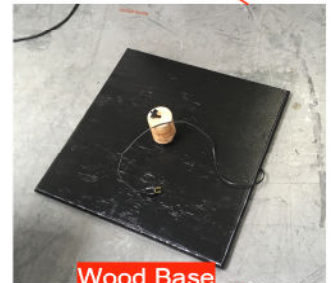

Wood Base

# SMALL LAMP POSTS